

Product Details

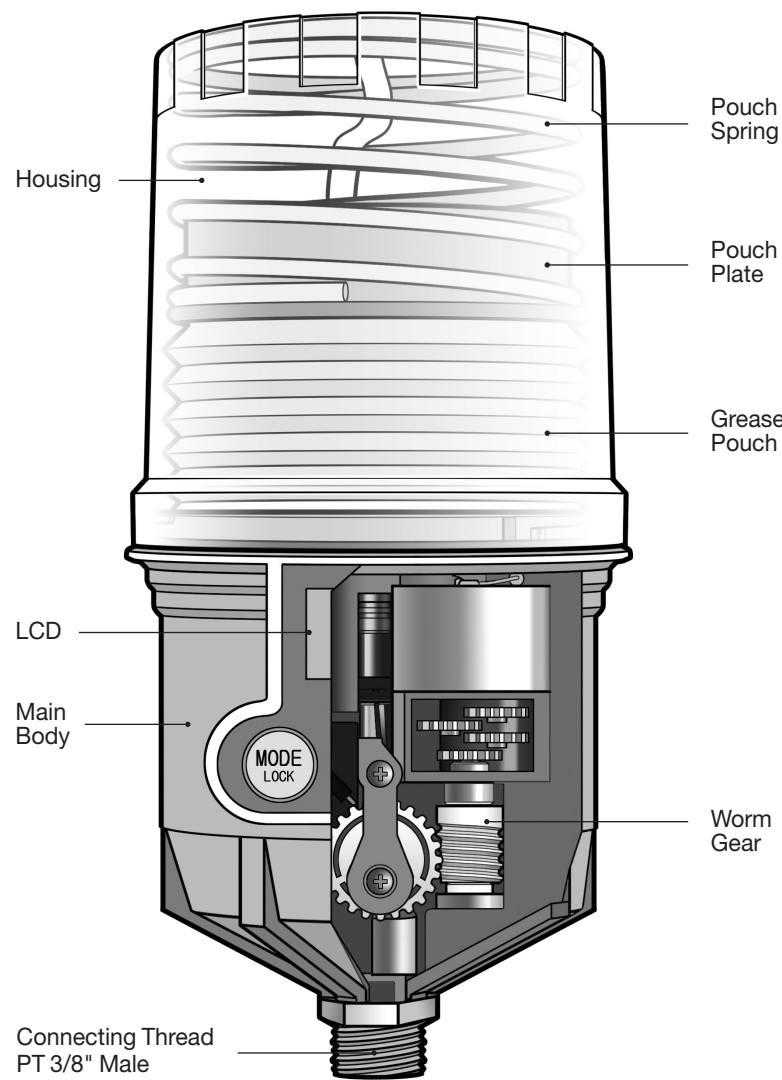

Installation Guidelines

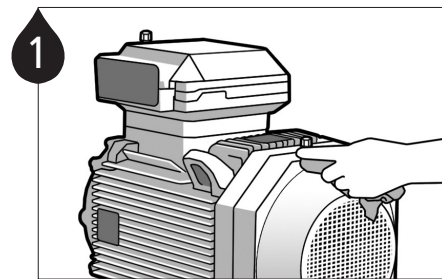

1 Remove contaminants around the lube point.

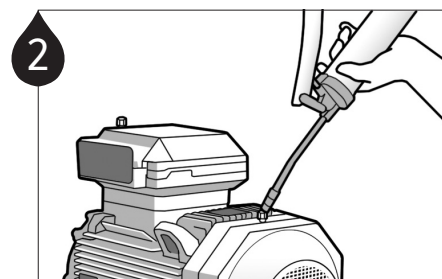

2 Ensure a clear passage using a manual grease gun. **Note1** Remove any hardened grease by purging the lube point with a manual grease gun. **Note2** The grease in the equipment and the grease contained in the unit should be the same or compatible.

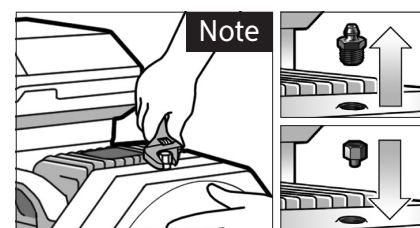

3 Remove the grease nipple and install appropriate adaptors.



4 Check the grease pouch capacity and the service pack items (battery pack, grease pouch & dust cover).

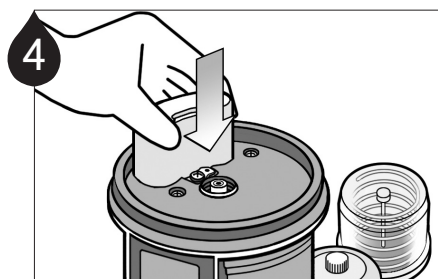

5 Insert a new battery pack.

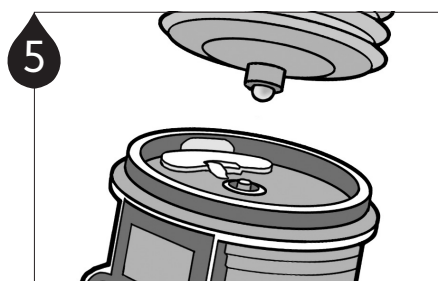

6 Purge the grease pouch until grease comes out of the tip.

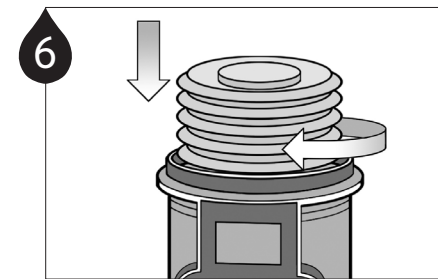

7 Carefully screw the grease pouch in by turning clockwise. Do not over tighten.

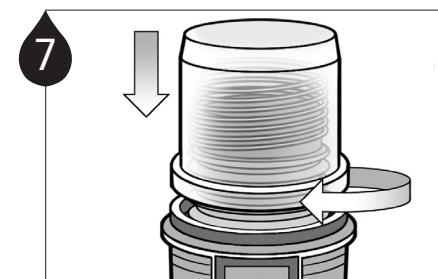

8 Refit the top housing on the unit and turn clockwise until it clicks.

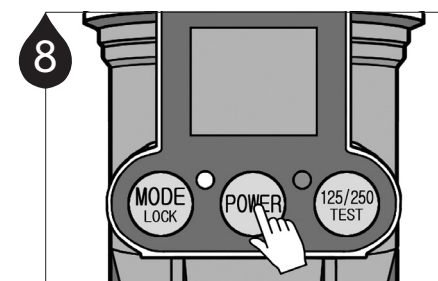

9 Press the MODE button for 2 seconds to turn the unit on.

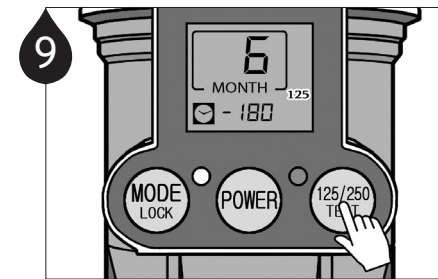

10 Select the appropriate grease pouch capacity by pressing the 125/250 TEST button.

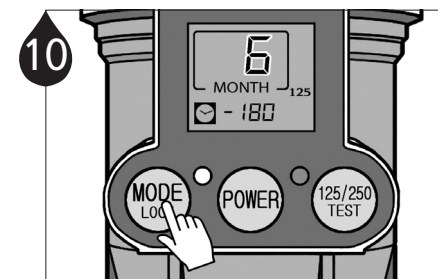

11 Press the MODE button to program the dispensing period.

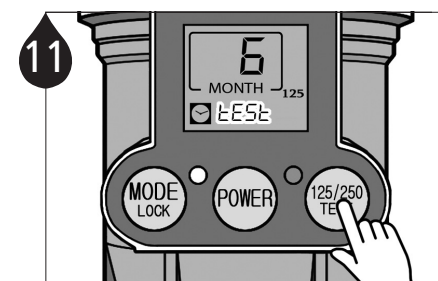

12 Press the TEST button for 2 seconds to run a test cycle and check for proper operation of the unit.

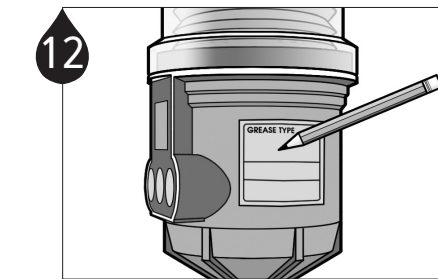

13 Note the installation date and the scheduled completion date of lube cycle on the lubricator using the label provided in the Service Pack for maintenance purposes.

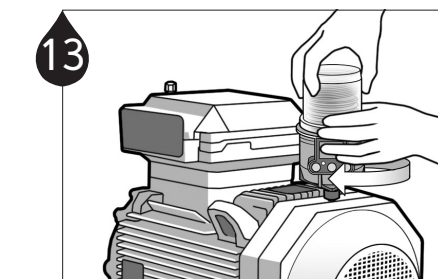

14 Install the Lubri-Cup EM-X unit on the lube point. When the selected dispensing period has completed, replace the unit with the Service Pack according to step #3-7.

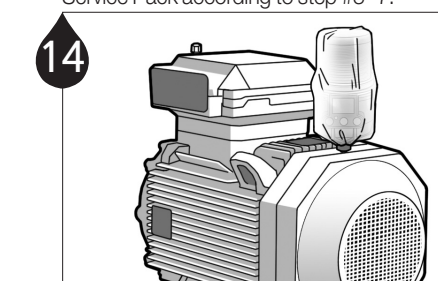

15 Install the dust cover over the lubricator for added protection.

Troubleshooting Guidelines

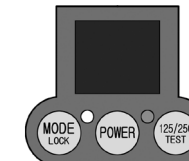

Symptom : Blank LCD screen
Possible Cause : Electrical malfunction of CPU or circuitry, battery problem
Solution : Replace battery pack or press reset button to restart the lubricator. If the problem persists, contact your supplier.

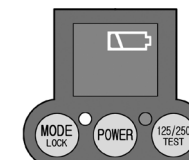

Symptom : Low Battery Indication
Possible Cause : Rapid power consumption due to improper storage or harsh operating conditions (temperature, humidity, or high backpressure).
Solution : Store the battery pack in cool, dry place and choose proper battery type for application. Optional lithium battery pack is available for more advanced applications.

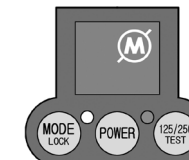

Symptom : Excessive Backpressure Indication
Possible Cause : Excessive backpressure due to hardened grease, over-lubrication, ruptured lube line, long distance remote installation, etc.
Solution : A) Check backpressure at lube point and/or lube line, B) check grease dispensing rate, C) reduce remote installation distance, or D) use manual grease gun to clear blockage.

Button Operation

MODE LOCK

Dispensing Period
Press to set dispensing period
1-12 month & 15 days (H)

Automatic Lock Out Mode
Press for 2 seconds to unlock (🔒)

POWER

Power **ON/OFF**
Press to Power unit On or Off

125/250 TEST

Grease Capacity
Press to select 125ml/250ml
TEST Mode
ON : Press for 2 seconds
OFF : Short press of button
(will stop after completion of ongoing cycle)

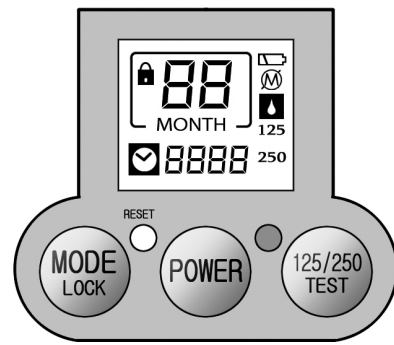

RESET Reset to default setting when the unit malfunctions and/or after changing the Service Pack

LCD Display

Dispensing period setting

Remaining dispensing days

Automatic Lock Out mode

125/250 Grease pouch capacity

TEST mode

Number of days since the cycle ended (🔒 and 📧 will also display)

Number of days operation has been on hold due to excessive backpressure

Low battery power

Operation on hold due to excessive backpressure

Empty grease level

LED blinks when battery is low, excessive backpressure exists, or grease level is empty

ISO9001/14001 CE

Product Certifications

The Lubri-Cup EM-X is tested and certified by UL (USA).

LISTED3JVL
Class I, Division 2,
Groups C and D

US 6.354.816
6.498.956
EP1 104 867

Mounting Methods

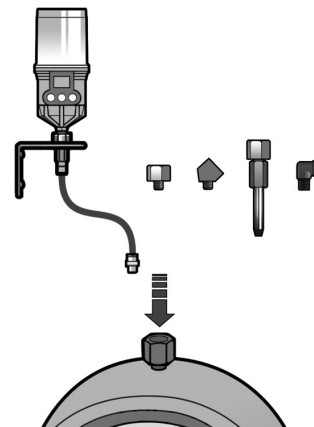

Single Point Installation
Direct Mount or Remote Installation using Extension Tube

Direct mount is always preferable. For applications not allowing any direct mounts, remotely mount the unit using appropriate accessories and keep the distance from the lube point as short as possible.

For remote installation using a tube, use a Ø6 O.D. (1/4") tubing pre-filled with the same or compatible grease as the grease contained in the unit.

Warning

Explosion Hazard - Do not remove or replace batteries unless power has been disconnected or the area is known to be free of ignitable concentrations of flammable gases or vapors.

▶ Replace battery with Lubri-Cup EM-X battery pack only. Use of another battery may present a risk of fire or explosion. See owner's manual for safety instructions.

This equipment is suitable for use in Class I, Division 2, Group C and D hazardous locations. (SUBSTITUTION OF MOTOR AND REED SWITCH MAY IMPAIR SUITABILITY FOR DIVISION 2)

Reference Designation	Description	Type of Protection
M1 SW4	Motor Reed Switch	Non-incendive Circuit Non-incendive Circuit



A.W. Chesterton Company

860 Salem Street, Groveland, MA 01834, USA
© 2019 A.W. Chesterton Company.
® Registered trademark owned and licensed by A.W. Chesterton Company in USA and other countries, unless otherwise noted. www.arc-epc.com

A.W. Chesterton Company makes no representations or warranties with respect to the completeness or accuracy of the data or information contained herein. A.W. Chesterton does not assume any liability for any losses or damages resulting from the use or application of the data or information contained herein. Application conditions may influence the outcome of the usage of the product. For specific guidance concerning usage and application conditions, please contact AWC IL/MRO Application Engineering at 978 469 2400.

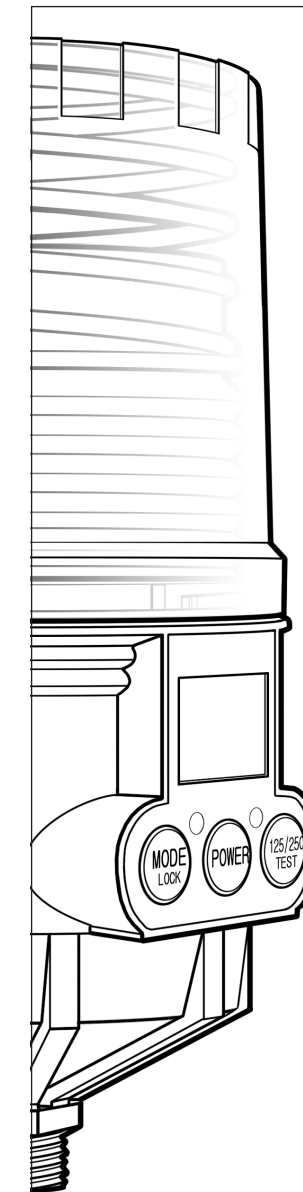

User Manual

LUBRI-CUP™ EM-X Series
(125&250ml)